

REPORT DRAWING ERRORS TO  
ENGINEERING DEPARTMENT

DWG. NO.  
**ST-9776-[ ]**

REV.  
**F**

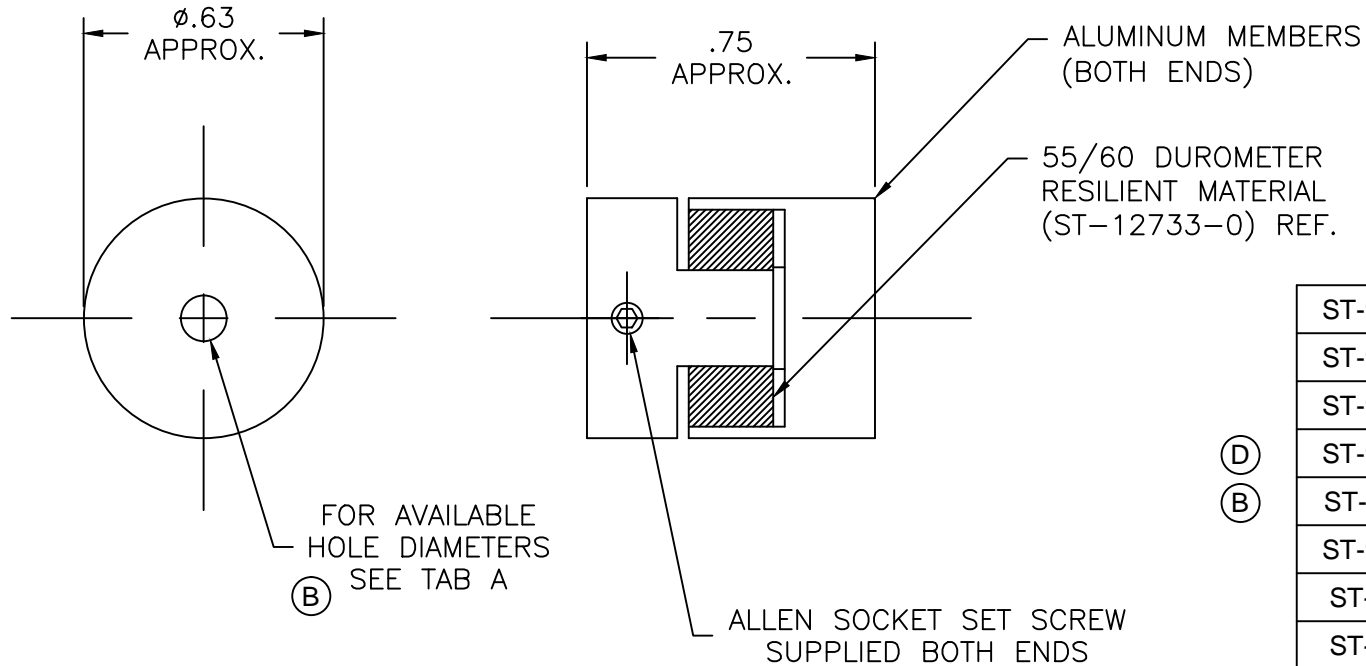

|            |       |          |
|------------|-------|----------|
| ST-9776-15 | .355  | .120     |
| ST-9776-14 | .375  | .250     |
| ST-9776-13 | .375  | .120     |
| ST-9776-12 | .375  | .187     |
| ST-9776-11 | 8 mm  | .187 (C) |
| ST-9776-10 | .250  | .312     |
| ST-9776-9  | .1875 | .312     |
| ST-9776-8  | .1875 | .250     |
| ST-9776-7  | .120  | .312     |
| ST-9776-6  | .120  | .250     |
| ST-9776-5  | .120  | .1875    |
| ST-9776-4  | .312  | .312     |
| ST-9776-3  | .250  | .250     |
| ST-9776-2  | .1875 | .1875    |
| ST-9776-1  | .120  | .120     |
| PART NO.   | TAB A |          |

**UNLESS OTHERWISE SPECIFIED THESE NOTES APPLY**

1. TOLERANCES: .XXXX ±.0005, .XXX ±.005, .XX ±.01, ANGLE ±0°30'
2. SHARP CORNERS AND EDGES BROKEN WITH .005 R OR CHAMFER.
3. DIAMETERS MUST BE CONCENTRIC TO (D) DIA. WITHIN .005 TIR.
4. ALL MALE THRESDS MUST BE NATIONAL FORM CLASS 3 FIT.
5. ALL FEMALE THREADS MUST BE NATIONAL FORM CLASS 2 FIT.

**SERVOTEK PRODUCTS, INC.**  
NEWELL, W. V.

| DATE     | BY     | CO#     |
|----------|--------|---------|
| 3/30/15  | EG     | --      |
| 11-19-13 | JUP JR | ST-0219 |
| 6-95     | DM     | 8116    |
| 4-94     | CK     | 8070    |
| 10-86    | CK     | 7728    |
| 11-85    | JW     | 7546    |

|                              |                                |                  |              |            |
|------------------------------|--------------------------------|------------------|--------------|------------|
| MAT'L                        | HEAT TREAT                     | FINISH           | DWN BY JW    | CHK BY CaP |
| ORIGINALLY DESIGNED FOR      | SCALE 2:1                      | DATE 11-12-85    | DATE 10-7-86 |            |
| PART NAME<br><b>COUPLING</b> | DWG. NO.<br><b>ST-9776-[ ]</b> | REV.<br><b>F</b> |              |            |